

MRGD SERIES

Rugged cast iron submersible pump provides capacities to 42 GPM and heads to 112 feet. Dual cutter design reduces sewage to a fine slurry. Dry motor features stainless steel shaft and ball bearings. Silicon carbide seals provide less friction, better resistance to wear, more thermal protection and greater corrosion resistance.

Options available are lift out system components, control panels, switches, alarms and basin assemblies.

APPLICATIONS

Sewage, effluent and wastewater removal or transfer, sewage grinding

SPECIFICATIONS

- Motor Housing – Cast iron
- Pump Casing – Cast iron
- Seal Housing – Cast iron
- Shaft – Stainless steel
- Impeller – Cast iron
- Cutters – Stainless steel 440C hardened to 55-60 Rockwell C dual cutter design
- Upper and Lower Bearings – Single row ball bearing shielded
- Fasteners – Stainless steel

In order to provide the best products possible, specifications are subject to change.

ORDERING INFORMATION

Catalog Number	HP	Volts	Phase*	Full Load Amps	Discharge
MRGD200PC2	2	230	1	13.4	1-1/4" NPT
MRGD200MC3	2	230/460	3	8.2/4.1	1-1/4" NPT

*3 phase models are pre-wired for 230 volt.

FEATURES

Motor

Dry motor design: Capacitor start/capacitor run which provides maximum starting torque required to start with trash. Motor windings contain automatic thermal overload protection. Single-phase unit has a time proven springloaded mechanical switch.

Mechanical Seals

Dual mechanical seals in cast iron housing filled with oil for lubrication. Seals are silicon carbide at the pump's water side and carbon ceramic at the motor side. Silicon carbide provides longer life at the critical seal area. Seal features Buna-N elastomers and stainless steel hardware.

Duty

Pumps are rated 105°F continuous, 122°F intermittent.

Shaft

Stainless steel eliminates corrosion and fatigue for longer pump life. Short shaft extension to reduce deflection and prolong seal and bearing life.

Float Switch

SJE Pumpmaster Plus 20'.

Impeller

Cast iron 10 vane for maximum clearing of particles.

Adjustable Mounting Feet

Stainless steel provided with rubber bottoms to reduce vibration.

Cord

14ga. SOW (3 phase) and 16ga SOW (1 phase) with secondary strain relief 20'.

**Continuous Duty
Dual Mechanical
Seals!**



This product is Listed to UL Standards for Safety by Underwriters Laboratories Inc. (UL).

OUTLINE DIMENSIONS

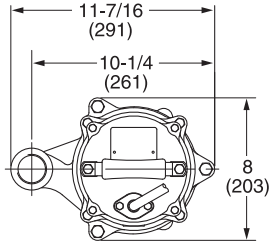

Phase	Dimension A
1	25 (635)
3	21-5/8 (549)

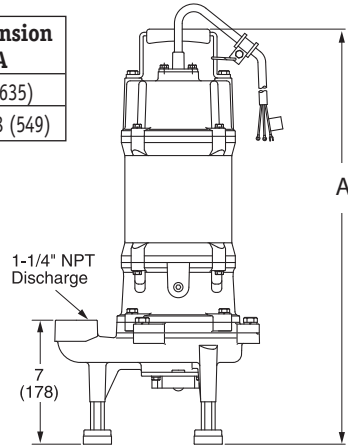

Dimensions in inches (mm) are for estimating purposes only.

CROSS SECTIONAL VIEW

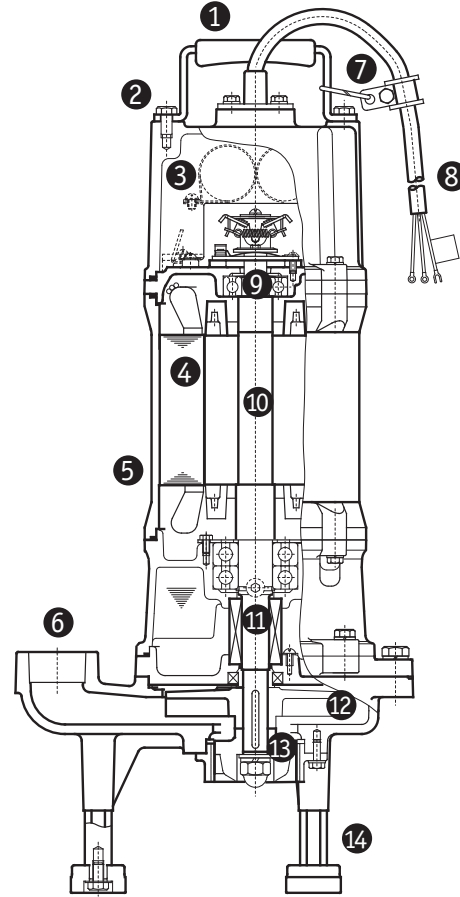

PUMP PERFORMANCE

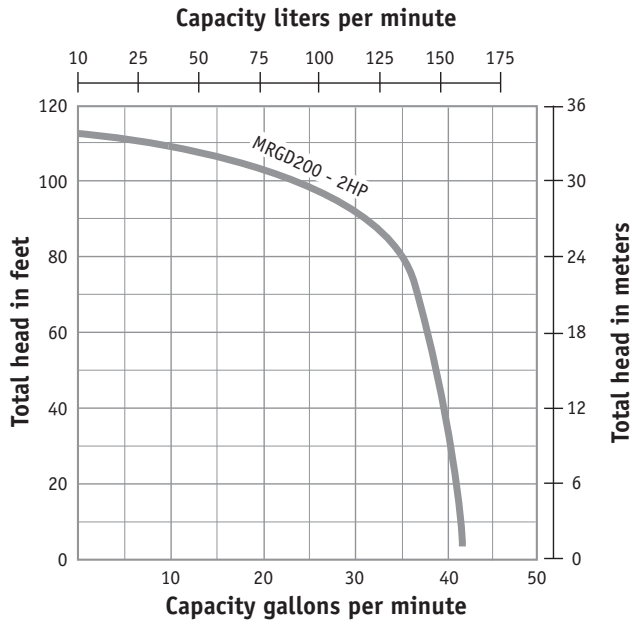

- ① Rubber coated handle
- ② All hardware stainless steel
- ③ Dry capacitor and switch housing for ease of servicing
- ④ Dry capacitor start/run motor provides maximum starting torque. No need for control panel on single phase units.
- ⑤ Cast iron housings with baked on epoxy coating to resist corrosion
- ⑥ 1-1/4" Discharge
- ⑦ Secondary cord strain relief
- ⑧ 14 gauge or 16 gauge SOW cord for maximum oil and water resistance. Easily serviceable.
- ⑨ Upper and lower heavy duty ball bearings
- ⑩ Stainless steel shaft
- ⑪ Dual mechanical seals in an oil chamber. Silicon carbide at the water end; carbon ceramic at the motor end.
- ⑫ Cast iron 10 vane impeller for maximum clearing of particles
- ⑬ Hardened 440c stainless cutters and cutting ring. Replaceable without disassembling pump.
- ⑭ Stainless steel legs with rubber feet adjustable to 1/2"